

## Cleaning and care

### Cleaning the central spout

Clean the central spout's stainless steel cover **by hand** only.

- Open the appliance door.

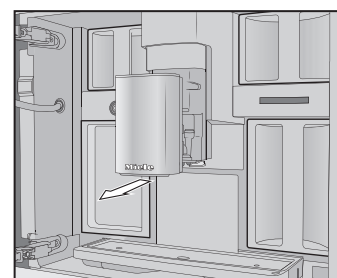

- Remove the central spout's stainless steel cover and clean it.

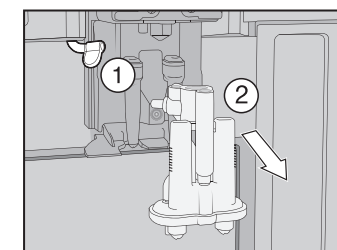

- Detach the milk pipework from the dispensing unit ①. Pull the dispensing unit down to remove it ②.

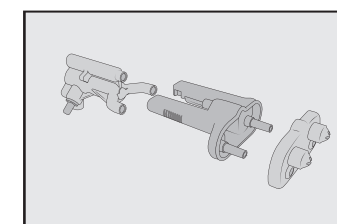

- Take the dispensing unit apart, separating it into 3 components.
- Clean all parts thoroughly. Clean the surfaces of the central spout with a damp cloth.

- Fit the dispensing unit back together.
- Push the dispensing unit back into the central spout and replace the stainless steel cover.
- Confirm the message with OK.

### Removing the brew unit and cleaning it by hand

Only clean the brew unit **by hand** with warm water. **Do not use any cleaning agents.**

- Open the appliance door and remove the water container.

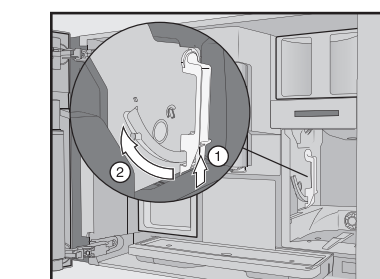

- Press the button under the handle of the brew unit ① and, whilst doing so, turn the handle forwards ②.

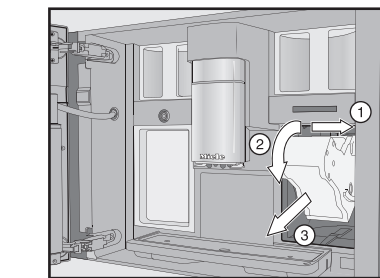

- First, pull the brew unit sideways ① and then slide it out forwards ②. Tilt the brew unit forwards ③.

When you have removed the brew unit, do not change the position of the handle on the brew unit.

- Clean the brew unit **by hand** under warm running water.

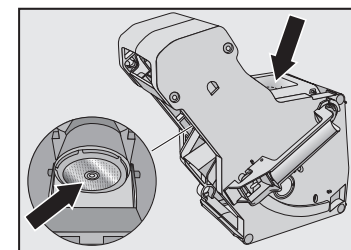

- Wipe any remaining coffee off the filters (see arrows).
- Dry the funnel in the brew unit.
- Carefully clean the inside of the coffee machine.
- Push the brew unit back into the coffee machine.
- Lock the brew unit. Press and hold the button under the brew unit handle and, whilst doing so, turn the handle to the right.
- Close the appliance door.
- Follow the further instructions given in the display.

The process is complete when rinsing has finished.

### Descaling the appliance

You will need **2** descaling tablets for the descaling programme.

The *Descal* the appliance message appears in the display.

- Touch OK.
- The maintenance programme will then start.
- Follow the instructions in the display.

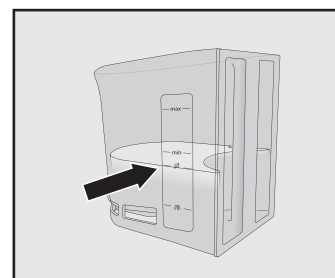

- Fill the water container to the descaling symbol  $\text{S}$  with lukewarm water.
- Drop **2** descaling tablets in the water.
- Push the water container back into the appliance.
- Follow the further instructions given in the display.

When *Rinse* the water container and fill with fresh water to the descaling symbol  $\text{S}$  appears in the display:

- Remove the water container and rinse it thoroughly with clean water. Fill the water container to the descaling symbol  $\text{S}$  with fresh tap water.

The descaling process is complete when rinsing has finished.

## Drinks overview

### Coffee drinks

- **Ristretto** is a strong, concentrated espresso. It is prepared with the same amount of coffee as for an espresso but with a lot less water.
- **Espresso** is a strong aromatic coffee with a thick hazelnut brown coloured froth – known as the crema – on top.
- **Coffee** differs from espresso by the increased amount of water and the roast of the beans.
- **Long coffee** is a coffee with considerably more water.
- **Long black** is made with hot water and two shots of espresso.
- **Caffè Americano** consists of equal proportions of espresso and hot water. The espresso is made first, then the hot water is dispensed into the cup.

### Coffee drinks made with milk

- **Cappuccino** consists of approx. 2/3 milk froth and 1/3 espresso.
- **Latte macchiato** consists of 1/3 each of hot milk, milk froth and espresso.
- **Caffè latte** consists of espresso and hot milk.
- **Cappuccino italiano** has the same proportions of milk froth and espresso as a cappuccino. The difference is that the espresso is added first and then the milk froth.
- **Espresso macchiato** is an espresso with a small amount of milk froth on top.
- **Flat white** is a special variety of cappuccino that contains significantly more espresso than milk froth for an intensive coffee aroma.
- **Café au lait** is a French style of coffee consisting of coffee and milk froth. Café au lait is usually served in a bowl.

### Tea drinks

- (hot water at the optimum temperature)
- White tea
- Japanese tea
- Green tea
- Herbal tea
- Fruit tea
- Black tea
- Chai Latte is a tea speciality with milk.

### Other drinks

- Hot milk
- Milk froth
- Hot water
- Warm water

### Pot function

- (3 to 8 cups can be selected)
- Coffee pot
- Teapot for all types of tea

## Coffee the way you like it

### Displaying and changing parameters

You can change the portion size for all drinks.

In addition, you set the quantity of coffee, the brewing temperature and pre-brewing for each coffee drink individually.

- Touch the  $\text{C}$  sensor control.
- Select a drink and confirm with OK.
- Touch Drink parameters.

The parameters that can be changed for this drink are displayed.

The *Portion size* menu option is displayed in the first line. If you select *Portion size* and confirm with OK, the drink will be dispensed immediately.

- Select the parameter you want and change the setting as required.
- Confirm with OK.

### Portion size

You can adjust the portion size for all coffee drinks, hot water, all types of tea and drinks with milk.

- Place a cup under the central spout.
- Select *Portion size* and confirm with OK.
- The drink will be prepared and *Save* will appear in the display.
- When the cup is filled to the level you want, touch OK.

If you want to change the portion size for coffee drinks made with milk or hot water, the ingredients which make up the drink will be saved one after the other while the drink is being made.

### Performance mode

You can select the appropriate mode to suit your personal preferences under Settings  $\text{M}$  | Performance mode. The energy consumption varies depending on the selected mode.

- **Eco mode:** This is an energy-saving mode.
- **Barista mode:** This mode is optimised for espresso and coffee drinks.
- **Latte mode:** In this mode, milk-based drinks can be prepared within a much shorter space of time.

In addition, you can activate **Party mode** for the occasional intensive use of the coffee machine, e.g. for family get-togethers (see the operating instructions).

## Settings

### Displaying and changing settings

- Touch the  $\text{C}$  sensor control.
- Select Settings  $\text{M}$  and touch OK.
- Select the menu option that you want to display or change. Touch OK.
- Change the setting as required and confirm with OK.

Factory default settings are marked in *italics*.

### Language

- German | ... other languages
- Location

### Time

- Display: On | Off | Night dimming
- Clock format: 24 h | 12 h (am/pm)
- Set

### Date

(Set)

### Timer

- Timer 1: Switch on at | Switch off at
- Timer 2: Switch on at | Switch off at
- Switch off after (0:20)

### TeaTimer

- Automatic | Manual

### Volume

- Buzzers
- Keypad tones
- Welcome melody: On | Off

### Display

- Brightness
- QuickTouch: On | Off

### Lighting

- Appliance switched on
- Appliance switched off: switch off after

You can also specify how long the lighting should stay on for when the appliance is switched off.

### Info

- Number of portions (Total no. of portions | Total coffees | ...)
- No. of portions until maintenance programme: Descal the appliance | Degrease the brew unit

### Fresh water (CVA 7445)

- On | Off

### Altitude

0–250 m, 251–500 m, ...

### Performance mode

- *Eco mode* | Barista mode | Latte mode | Party mode

Party mode is a Performance mode for the occasional intensive use of the coffee machine (see the operating instructions).

### Water hardness

- Overall hardness

Set to 21 °dH by default.

### System lock

- On | Off

When the system lock is activated, the *Switch on at* option for the timer cannot be selected.

### Miele@home

- Setup | Deactivate/activate | Connection status | New setup

Some menu options only appear if Miele@home has been set up and the coffee machine has – where applicable – been connected to a WiFi network.

### Remote control

- On | Off

### RemoteUpdate

- On | Off

### Software version

For the Customer Service Department

### Showroom

- Demo mode: On | Off

### Factory default settings

- Appliance settings: Reset | Do not reset

Language, Time, Date, Number of portions, Miele@home settings, Profiles and the corresponding drinks cannot be reset.

# Miele

## Quick Start Guide Coffee machine



These short instructions are **not** a substitute for the operating instructions supplied with the machine. It is essential to familiarise yourself with the coffee machine before using it for the first time. Please read the operating instructions carefully and pay particular attention to the Warning and Safety instructions.

## Operation

### Controls and indicators

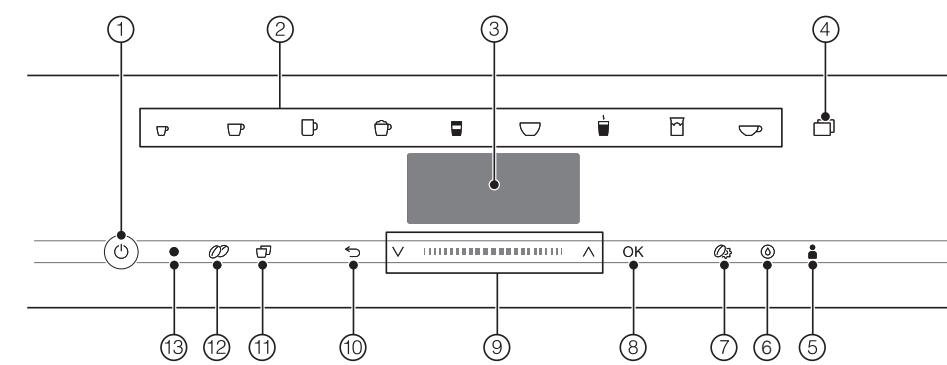

- 1 On/Off button
- 2 Drink buttons
- 3 Display
- 4 Sensor control
- 5 Profile sensor control
- 6 Maintenance sensor control
- 7 Parameters sensor control
- 8 OK sensor control
- 9 Navigation area with arrow buttons
- 10 "Back" sensor control
- 11 "2 portions" sensor control
- 12 "DoubleShot" sensor control
- 13 Optical interface (for the Miele Customer Service Department only)

### Explanation of drink symbols

- Espresso
- Coffee
- Long coffee
- Cappuccino
- Latte macchiato
- Caffè latte
- Hot milk
- Milk froth
- Tea water

### Operation

To operate the coffee machine, touch the sensors with your finger.

#### Drinks menu

You are in the drinks menu when **Select drink** appears in the display.

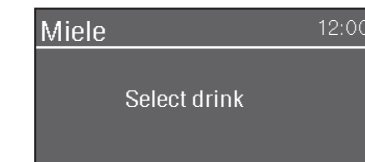

You can find more drinks in the **Further drinks menu** (sensor control).

### Navigation area

To select a menu option, keep pressing the arrow buttons  $\nabla/\wedge$  until the option you want is highlighted.

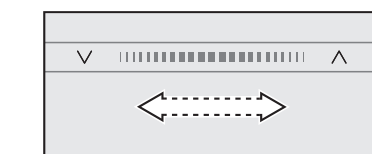

To scroll more quickly through the options, swipe your finger right or left in the area between the arrows.

As soon as you reach a confirmable value, message or setting, the **OK** sensor control will light up orange.

Touch the **OK** sensor control to confirm your selection.

#### Selecting a menu and navigating within a menu

To select a menu, touch the relevant sensor control, e.g. the sensor control.



You will then be able to start an action or change settings in the menu. A bar on the right-hand side of the display indicates that further options or text are available.

The setting which is currently selected in a list will have a tick  $\checkmark$  beside it.

#### Exiting a menu or cancelling an action

To exit the current menu, touch the sensor control.

Alternatively, touch the lit orange sensor control again to return to the drinks menu.

### Entering a name

Letters and numbers are entered via the navigation area. You can choose between upper and lower case letters.

**Tip:** It is best to select short names.



To enter a character, highlight the one you want and confirm your choice with **OK**.

To delete a character, touch the sensor control.

To save the name, select the tick  $\checkmark$  and confirm with **OK**.

### Exterior view

- 1 On/Off button
- 2 Control panel
- 3 Door handle
- 4 Height-adjustable central spout with lighting
- 5 Drip tray cover
- 6 Milk flask

### Interior view

- 1 Bean container
- 2 Milk valve
- 3 Height-adjustable central spout with lighting
- 4 Grinder setting
- 5 Bean container
- 6 Fan outlet
- 7 Water container
- 8 Drip tray with lid
- 9 Brew unit
- 10 Waste container
- 11 Maintenance container
- 12 Drip tray

## Preparing for use

### Filling the water container

- Open the appliance door.

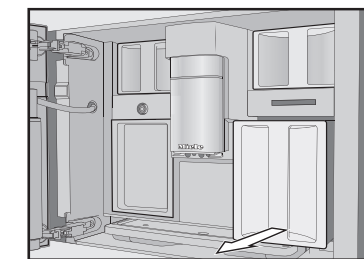

- Pull the water container forwards to remove it.
- Fill the water container with fresh, cold tap water up to the "max." mark.
- Push the water container back into the coffee machine and close the appliance door.

### Filling the bean container

Only put roasted coffee beans in the bean container.

- Open the appliance door.

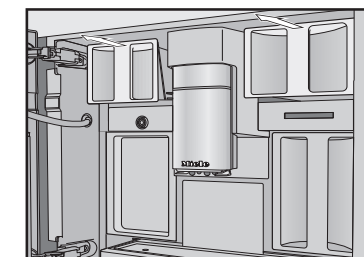

- Pull the bean containers out and take off the lids.
- Fill the bean containers with coffee beans and put the lids back on the bean containers to seal them.
- Push the bean containers all the way back into the coffee machine.
- Close the appliance door.

## Making drinks

### Making a drink

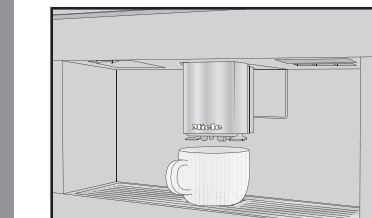

- Place a cup under the central spout.
- Touch the sensor control for the drink you want.

### Cancelling a drink

- Touch the lit orange symbol on the control panel again.

When preparing drinks with several ingredients (e.g. latte macchiato) you can cancel each of the individual components prematurely.

- Touch **OK** when **Stop** appears in the display.

### DoubleShot

Select the **DoubleShot** function if you would like a particularly strong and aromatic coffee. In this case, more coffee beans will be ground and brewed halfway through brewing.

- Touch the sensor control whilst making your coffee.

### Making two portions (sensor control)

To fill two cups at the same time:

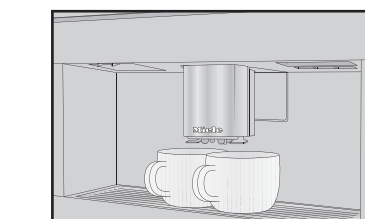

- Place a cup under each of the coffee dispensers in the central spout.
- Touch the sensor control whilst making your drink.

### Using the milk flask

Milk is not cooled in the milk flask. Therefore, place the milk flask in the refrigerator if you are not going to use milk for a while. Good milk froth can only be made with cold milk ( $< 10^\circ\text{C}$ ).

- Fill the milk flask with milk up to a maximum of 2 cm below the rim.

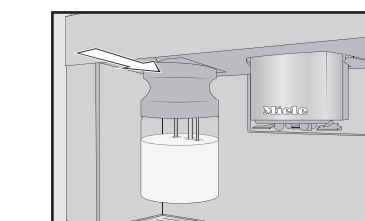

- Push the milk flask back into the coffee machine until it clicks into place. You can now make drinks with milk.

### Making tea

Hot water is heated to the optimum temperature for different types of tea.

Touch the sensor control to access the menu containing the various types of tea.

- Place the tea filter or the tea bag in the tea cup.
- Place the tea cup under the central spout.
- Select the type of tea you want and confirm your choice with **OK**.

Hot water will be dispensed into the cup. Remove the tea filter or tea bag when the desired brewing time has elapsed.

**Tip:** You can use the **TeaTimer** function to start a minute minder when making tea (see the operating instructions).

### Pot function

You can make several cups of coffee or tea one after the other automatically with the **Pot** function (maximum of 1 litre). This can make up to 8 cups.

#### Preparing the pot

The drinks menu is displayed.

- Place a sufficiently large container under the central spout.
- Select the pot function you want:
  - Coffee pot:** Touch the sensor control and select **Coffee pot**. Confirm with **OK**.
  - Teapot:** Touch the drinks sensor and select **Teapot**.
- Select the number of cups you want (3 to 8).
- Follow the instructions in the display.

### Expert mode

The **Expert mode** function allows you to change the portion size while the drink is being made (**Settings** | **Expert mode**).

The setting will **not** be saved and will only apply for the current drink.

The **Expert mode** function is switched off as the factory default setting.

#### Changing the portion sizes

The portion size can only be changed during the individual preparation stages.

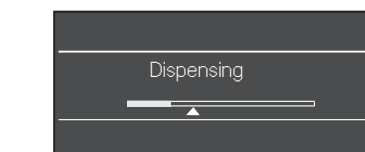

- While the drink is being made: move the indicator (small triangle) across the navigation area according to the portion size you want.

## Cleaning and care

Please observe the detailed information on cleaning and care in the operating instructions. Carefully clean the coffee machine regularly.

Recommended cleaning interval	What do I have to clean/maintain?
<b>Every day</b> (at the end of the day)	<ul style="list-style-type: none"> <li>Milk flask and lid</li> <li>Milk valve</li> <li>Water container</li> <li>Drip tray cover</li> <li>Drip tray and waste container</li> </ul>
<b>Once a week</b> (more often if heavily soiled)	<ul style="list-style-type: none"> <li>Central spout</li> <li>Cup rim sensor</li> <li>Interior cabinet</li> <li>Brew unit</li> <li>Drip tray</li> <li>Appliance front</li> </ul>
<b>Once a month</b>	<ul style="list-style-type: none"> <li>Bean containers</li> </ul>
<b>As and when required/after prompt appears in display</b>	<ul style="list-style-type: none"> <li>Milk pipework</li> <li>Degrease the brew unit</li> <li>Descalc the appliance</li> </ul>

### Cleaning by hand or in the dishwasher

#### Clean the following by hand only:

- Stainless steel cover of the central spout
- Brew unit
- Bean containers and lids

#### The following can be cleaned in the dishwasher:

- Drip tray, lid and waste container
- Drip tray cover
- Central spout (without stainless steel cover)
- Milk flask and lid
- Cup rim sensor
- Drip tray
- Maintenance container
- Water container